

### RUKS35-D-A-SR [↗](#)

#### Braking/clamping element

Clamping element RUKS...-D-A-SR, for linear recirculating roller bearing and guideway assembly, oil connector on side

## Technical information

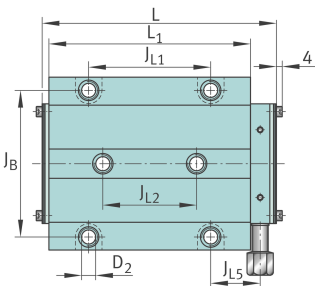
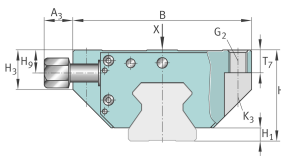

### Your current product variant

Size code	35	
Version	D	
Internal design	A	
Oil feed	SR	Oil connector on side

### Main Dimensions & Performance Data

H	48 mm	Height sytem
B	98 mm	Width clamping element
L	134,3 mm	Length of clamping element
≈m	2,44 kg	Weight

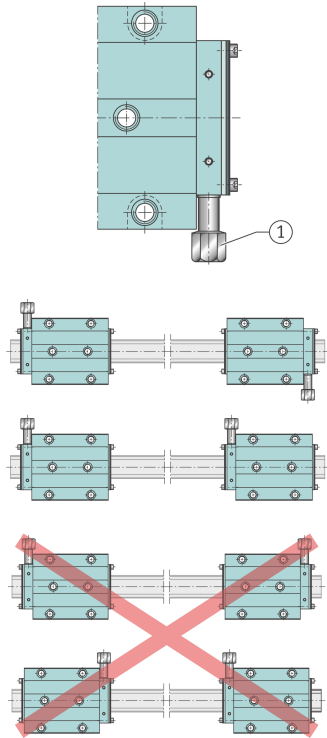

### Mounting dimensions

J <sub>B</sub>	82 mm	Hole pattern width
A <sub>3</sub>	24,5 mm	Mounting dimension oil connector
L <sub>1</sub>	113 mm	Length saddle plate
J <sub>L1</sub>	62 mm	Hole pattern lengthwise
J <sub>L2</sub>	52 mm	Hole pattern centre
J <sub>L5</sub>	32 mm	Distance
N <sub>2 max</sub>	6 mm	Max diameter lubrication hole adjacent constr
H <sub>1</sub>	6,8 mm	Space (system)
H <sub>3</sub>	21 mm	
T <sub>7</sub>	12 mm	Depth thread
H <sub>9</sub>	13,4 mm	
G <sub>2</sub>	M10	Size thread above for DIN ISO 4762-12.9
M G <sub>2</sub>	41 Nm	Tightening torque above
K <sub>3</sub>	M8	Size thread below for DIN ISO 4762-12.9
M K <sub>3</sub>	41 Nm	Tightening torque below
D <sub>2</sub>	8,6 mm	Through-bore

### Related products

TSX35-E; TSX35-F	Suitable guideway
RUE35-E; RUE35-F	Suitable system