

**RTUE20-XL**

## Take-up housing unit

Take-up housing units RTUE, cast iron housing, radial insert ball bearing with eccentric locking collar, R seals

X-life

## Technical information

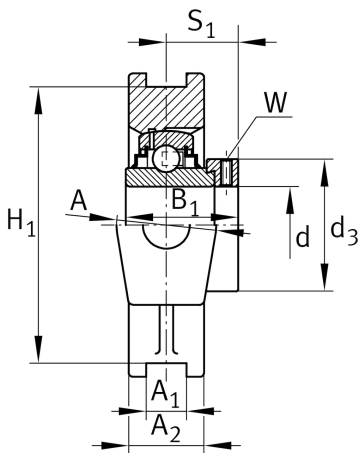

## Your current product variant

|          |    |                |
|----------|----|----------------|
| Material | GG | Grey cast iron |
|----------|----|----------------|

## Main Dimensions &amp; Performance Data

|                |         |                            |
|----------------|---------|----------------------------|
| d              | 20 mm   | Bore diameter              |
| H              | 90 mm   | Height                     |
| L              | 94,5 mm | Length total               |
| B <sub>1</sub> | 43,7 mm | Locking collar total width |
| m              | 0,9 kg  | Weight                     |

## Mounting dimensions

|                |          |  |
|----------------|----------|--|
| A <sub>1</sub> | 12 mm    | Width guidance groove                    |
|                | H13      | Width guidance groove clearance          |
| H <sub>1</sub> | 76 mm    | Distance guidance grooves                |
|                | 0,15 mm  | Upper distance guidance groove tolerance |
|                | -0,15 mm | Lower distance guidance groove tolerance |
| N              | 19 mm    | Fixing bore                              |



### Dimensions

|                |         |                                       |
|----------------|---------|---------------------------------------|
| L <sub>1</sub> | 60 mm   | Distance shaft axis                   |
| L <sub>2</sub> | 9 mm    | Length fixed link                     |
| L <sub>3</sub> | 50 mm   | Length guidance groove                |
| A              | 37 mm   | Width housing fixing side             |
| N <sub>1</sub> | 18 mm   | Width recess                          |
| N <sub>2</sub> | 32 mm   | Height recess                         |
| S <sub>1</sub> | 26,6 mm | Distance of raceway to locking collar |
| T              | 51 mm   | Height housing fixing side            |
| Q              | M6      | Connection thread for lubrication     |
| A <sub>2</sub> | 25 mm   | Width housing                         |

### Additional information

|               |                     |
|---------------|---------------------|
| TUE04         | Housing             |
| GE20-XL-KRR-B | Bearing designation |

### Temperature range

|                  |        |                            |
|------------------|--------|----------------------------|
| T <sub>min</sub> | -20 °C | Operating temperature min. |
| T <sub>max</sub> | 120 °C | Operating temperature max. |