

## LFDL32-B [↗](#)

Carriage

bogie carriage

### Technical information

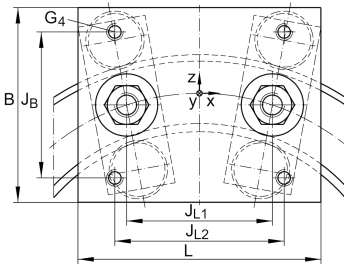
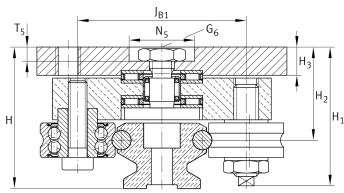

### Your current product variant

Size code	32
Setting	B

### Main Dimensions & Performance Data

H <sub>1</sub>	43 mm	
B	80 mm	
L	100 mm	
≈m	0,8 kg	Weight

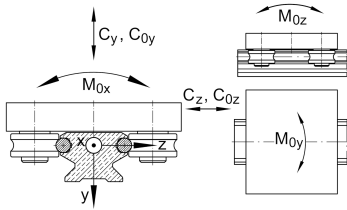

### Mounting dimensions

G <sub>4</sub>	M8	
G <sub>6</sub>	M8	
H	44,2 mm	Total height of carriage and rail at LFS, -C, -CE, -CEE, -E, -EE, -N, -NZZ
H <sub>2</sub>	29,2 mm	
H <sub>2 Tol</sub>	0,3	
H <sub>2 Tol</sub>	0	
H <sub>3</sub>	9 mm	
J <sub>B</sub>	60 mm	
J <sub>B1</sub>	54 mm	
J <sub>L1</sub>	60 mm	
J <sub>L2</sub>	70 mm	
N <sub>5</sub>	21 mm	
T <sub>5</sub>	5 mm	

### Main dimensions

M <sub>A</sub>	15 Nm	Tightening torque (standard version)
C <sub>y</sub>	4.100 N	Basic dynamic load rating in y-direction
C <sub>0y</sub>	2.400 N	Basic static load rating in y-direction
C <sub>z</sub>	6.600 N	Basic dynamic load rating in z-direction
C <sub>0z</sub>	4.200 N	Basic static load rating in z-direction
M <sub>0x</sub>	30 Nm	Static moment about X-axis
M <sub>0y</sub>	130 Nm	Static moment about Y-axis
M <sub>0z</sub>	70 Nm	Static moment about Z-axis

### Related products

LFR	LFR50/8-6-2Z	Used track roller
LFS	LFS32	Guide rail