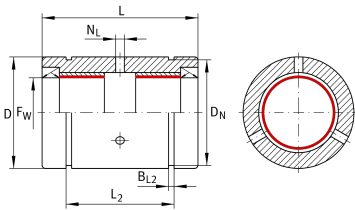

**PAB25-PP-AS**

Linear plain bearing

Linear plain bearing; sealed on all sides, with relubrication facility

## Technical information

**Your current product variant**

Size code	25
Seal	PP
Relubrication	AS

**Main Dimensions & Performance Data**

$F_W$	25 mm	Diameter of ball complement
$D$	40 mm	Outer diameter
Tol $D$	h7	Tolerance
$L$	58 mm	Length
Tol $L$	h12	Tolerance
$C_0$	250.000 N	Load capacity stat. $C_0$
$\approx m$	0,131 kg	Weight

**Mounting dimensions**

$L_2$	43,7 mm	Mounting Dimension
Tol $L_2$	H13	Tolerance
$B_{L2}$	1,85 mm	
Tol $B_{L2}$	H13	Tolerance
$D_N$	37,5 mm	
$N_L$	2,5 mm	
Tol $N_L$	H13	Tolerance