

**KTHK40-B-PP-AS** [↗](#)

Linear Ball Bearing and Housing Unit

Linear ball bearing and housing unit; sealed, greased, with relubrication facility; corrosion-resistant design possible

Technical information

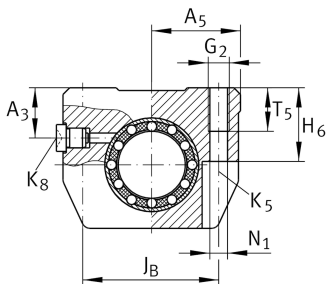
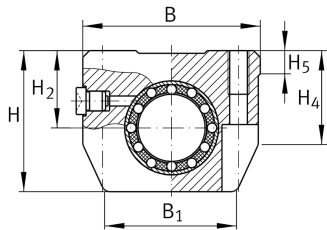

Your current product variant

Size code	40
Version	B
Seal	PP
Relubrication facility	AS

Main Dimensions & Performance Data

F _W	40 mm	Diameter of ball complement
H	73,5 mm	Height
L	125 mm	Length
B	87 mm	Width
C	8.600 N	Load capacity dyn. C
C ₀	6.900 N	Load capacity stat. C ₀
≈m	1,6 kg	Weight

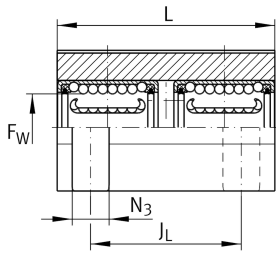

Mounting dimensions

J _B	69 mm	
Tol J _B	+ 0,15 mm	Upper tolerance
Tol J _B	- 0,15 mm	Lower tolerance
B ₁	63 mm	
A ₅	43,5 mm	
J _L	85 mm	Distance
Tol J _L	+ 0,15 mm	Upper tolerance
Tol J _L	- 0,15 mm	Lower tolerance
H ₂	39 mm	Center height
Tol H ₂	+ 0,01 mm	Upper tolerance
Tol H ₂	- 0,014 mm	Lower tolerance
H ₄	49,7 mm	
H ₅	12,8 mm	
T ₅	22 mm	
H ₆	38 mm	
A ₃	23 mm	
G ₂	M10	
N ₁	8,4 mm	
N ₃	18 mm	
K ₅	M8	
K ₈	NIPA2	Lubrication nipple