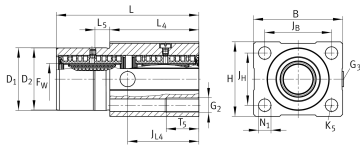
**KTFS25-PP-AS**

Linear Ball Bearing and Housing Unit

Linear ball bearing and housing unit; with self-aligning linear ball bearing, sealed, greased, with relubrication facility

Technical information

**Your current product variant**

Size code	25
Seal	PP
Relubrication	AS

Technical data

	8	Ball rows
≈m	0,9 kg	Weight

Main Dimensions & Performance Data

F _w	25 mm	Diameter of ball complement
H	60 mm	Height
L	122 mm	Length
B	74 mm	Width
C _{min}	4.400 N	Load capacity dyn. C
C _{0 min}	4.850 N	Load capacity stat. C0



Mounting dimensions

J _B	56 mm	
Tol J _B	+ 0,15 mm	Upper tolerance
Tol J _B	- 0,15 mm	Lower tolerance
L ₄	73 mm	
L ₅	10 mm	
J _{L4}	61 mm	Distance
D ₁	52 mm	Diameter
Tol D ₁	g7	Tolerance
D ₂	52 mm	Diameter
Tol D ₂	- 0,1 mm	Upper tolerance
Tol D ₂	- 0,3 mm	Lower tolerance
J _H	42 mm	
Tol J _H	+ 0,15 mm	Upper tolerance
Tol J _H	- 0,15 mm	Lower tolerance
T ₅	26 mm	Thread depth
G ₂	M12	Thread size
N ₁	10,5 mm	Diameter
K ₅	M10	
G ₃	M8x1	Thread size