**KFB50-B-PP-AS**

Linear Ball Bearing and Housing Unit

Linear ball bearing and housing unit; with flange, sealed, greased, with relubrication facility; corrosion-resistant design possible

Technical information

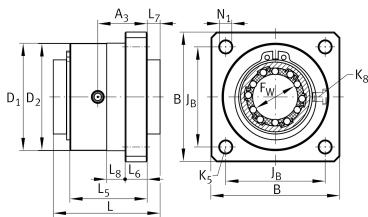

Your current product variant

Size code	50
Seal	PP
Relubrication facility	AS

Technical data

	6	Ball rows
≈m	2,15 kg	Weight

Main Dimensions & Performance Data

F _w	50 mm	Diameter of ball complement
Tol F _w	+ 0,013 mm	Upper tolerance
Tol F _w	- 0,002 mm	Lower tolerance
L	100 mm	Length
B	130 mm	Width
C	8.700 N	Load capacity dyn. C
C ₀	6.300 N	Load capacity stat. C ₀



Mounting dimensions

L ₅	75 mm	
L ₆	18 mm	Thickness
L ₇	11,2 mm	
A ₃	38,8 mm	
N ₁	11 mm	Diameter
K ₅	M10	
D ₁	97,5 mm	Diameter
Tol D ₁	+ 0,2 mm	Upper tolerance
D ₂	98 mm	Diameter
Tol D ₂	g7	Upper tolerance
J _B	98 mm	
L ₈	10 mm	
K ₈	NIPA2	Lubrication nipple