**KFB30-B-PP-AS**

## Linear Ball Bearing and Housing Unit

Linear ball bearing and housing unit; with flange, sealed, greased, with relubrication facility; corrosion-resistant design possible

## Technical information

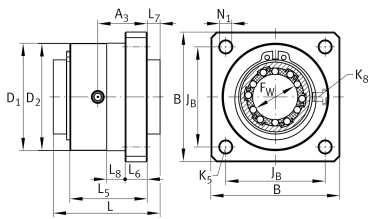

## Your current product variant

Size code	30
Seal	PP
Relubrication facility	AS

## Technical data

	6	Ball rows
≈m	0,62 kg	Weight

## Main Dimensions &amp; Performance Data

F <sub>w</sub>	30 mm	Diameter of ball complement
Tol F <sub>w</sub>	+ 0,011 mm	Upper tolerance
Tol F <sub>w</sub>	- 0,001 mm	Lower tolerance
L	68 mm	Length
B	80 mm	Width
C	3.600 N	Load capacity dyn. C
C <sub>0</sub>	2.850 N	Load capacity stat. C0



### Mounting dimensions

L <sub>5</sub>	50 mm	
L <sub>6</sub>	14 mm	Thickness
L <sub>7</sub>	8 mm	
A <sub>3</sub>	26 mm	
N <sub>1</sub>	9 mm	Diameter
K <sub>5</sub>	M8	
D <sub>1</sub>	65,5 mm	Diameter
Tol D <sub>1</sub>	+ 0,2 mm	Upper tolerance
D <sub>2</sub>	66 mm	Diameter
Tol D <sub>2</sub>	g7	Upper tolerance
J <sub>B</sub>	60 mm	
L <sub>8</sub>	10 mm	
K <sub>8</sub>	NIPA1	Lubrication nipple