



IMAGE COMING SOON



KTSO16-PP-AS [↗](#)

Linear Ball Bearing and Housing Unit

Linear ball bearing and housing unit; open design, with self-aligning linear ball bearing, contact seals on both sides

Technical information

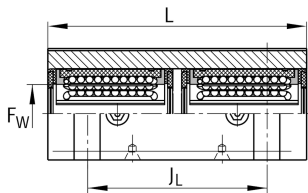
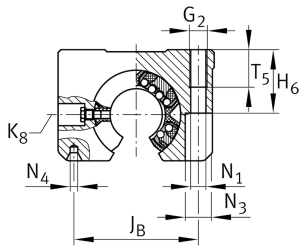
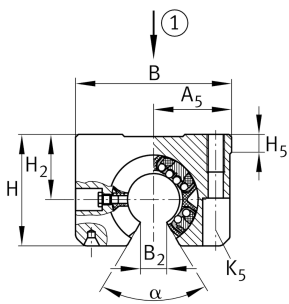

Your current product variant

| | |
|------------------------|----|
| Size code | 16 |
| Seal | PP |
| Relubrication facility | AS |

Technical data

| | | |
|----|---------|-----------|
| | 6 | Ball rows |
| ≈m | 0,52 kg | Weight |

Main Dimensions & Performance Data

| | | |
|--------------------|---------|-----------------------------|
| F _w | 16 mm | Diameter of ball complement |
| H | 35 mm | Height |
| L | 78 mm | Length |
| B | 53 mm | Width |
| C _{max} | 2.330 N | Load capacity dyn. |
| C _{0 max} | 3.100 N | Load capacity stat. |

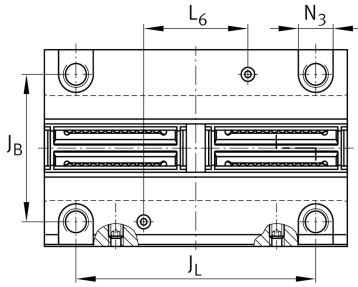

Mounting dimensions

| | | |
|--------------------|------------|--------------------|
| J _B | 40 mm | |
| Tol J _B | + 0,15 mm | Upper tolerance |
| Tol J _B | - 0,15 mm | Lower tolerance |
| A ₅ | 26,5 mm | |
| Tol A ₅ | + 0,01 mm | Upper tolerance |
| Tol A ₅ | - 0,01 mm | Lower tolerance |
| B ₂ | 10,1 mm | |
| J _L | 64 mm | Distance |
| Tol J _L | + 0,15 mm | Upper tolerance |
| Tol J _L | - 0,15 mm | Lower tolerance |
| L ₆ | 26 mm | Distance |
| H ₂ | 22 mm | Center height |
| Tol H ₂ | + 0,008 mm | Upper tolerance |
| Tol H ₂ | - 0,016 mm | Lower tolerance |
| H ₅ | 7,5 mm | |
| T ₅ | 13 mm | |
| H ₆ | 21 mm | |
| G ₂ | M6 | |
| N ₁ | 5,3 mm | |
| N ₄ | 1.6x3.35 | |
| N ₃ | 10 mm | |
| K ₅ | M5 | |
| K ₈ | NIP4MZ | Lubrication nipple |
| α | 68 ° | Angle |