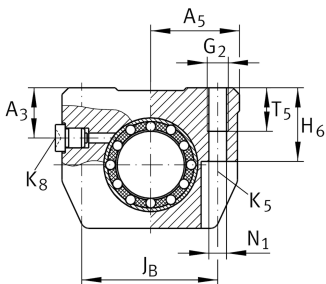
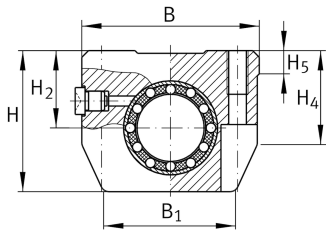

**KTHK20-B-PP-AS** [↗](#)

Linear Ball Bearing and Housing Unit

Linear ball bearing and housing unit; sealed, greased, with relubrication facility; corrosion-resistant design possible

Technical information

**Your current product variant**

Size code	20
Version	B
Seal	PP
Relubrication facility	AS

Main Dimensions & Performance Data

F _W	20 mm	Diameter of ball complement
H	42,5 mm	Height
L	65 mm	Length
B	53 mm	Width
C	1.800 N	Load capacity dyn. C
C ₀	1.580 N	Load capacity stat. C ₀
≈m	0,315 kg	Weight

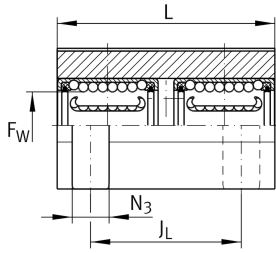

Mounting dimensions

J _B	40 mm	
Tol J _B	+ 0,15 mm	Upper tolerance
Tol J _B	- 0,15 mm	Lower tolerance
B ₁	40 mm	
A ₅	26,5 mm	
J _L	45 mm	Distance
Tol J _L	+ 0,15 mm	Upper tolerance
Tol J _L	- 0,15 mm	Lower tolerance
H ₂	23 mm	Center height
Tol H ₂	+ 0,01 mm	Upper tolerance
Tol H ₂	- 0,014 mm	Lower tolerance
H ₄	29,8 mm	
H ₅	7,4 mm	
T ₅	13 mm	
H ₆	22 mm	
A ₃	15 mm	
G ₂	M6	
N ₁	5,3 mm	
N ₃	11 mm	
K ₅	M5	
K ₈	NIPA2	Lubrication nipple