**KFB12-B-PP-AS**

Linear Ball Bearing and Housing Unit

Linear ball bearing and housing unit; with flange, sealed, greased, with relubrication facility; corrosion-resistant design possible

Technical information

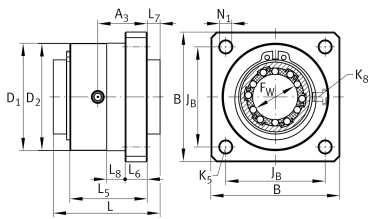

Your current product variant

Size code	12
Seal	PP
Relubrication facility	AS

Technical data

	5	Ball rows
≈m	0,08 kg	Weight

Main Dimensions & Performance Data

F _w	12 mm	Diameter of ball complement
Tol F _w	+ 0,008 mm	Upper tolerance
L	32 mm	Length
B	40 mm	Width
C	540 N	Load capacity dyn. C
C ₀	385 N	Load capacity stat. C ₀



Mounting dimensions

L ₅	22 mm	
L ₆	6 mm	Thickness
L ₇	4,2 mm	
A ₃	11,5 mm	
N ₁	5,5 mm	Diameter
K ₅	M5	
D ₁	31,5 mm	Diameter
Tol D ₁	+ 0,2 mm	Upper tolerance
D ₂	32 mm	Diameter
Tol D ₂	g7	Upper tolerance
J _B	30 mm	
L ₈	10 mm	
K ₈	NIPD3	Lubrication nipple