**KFB40-B-PP-AS**

Linear Ball Bearing and Housing Unit

Linear ball bearing and housing unit; with flange, sealed, greased, with relubrication facility; corrosion-resistant design possible

Technical information

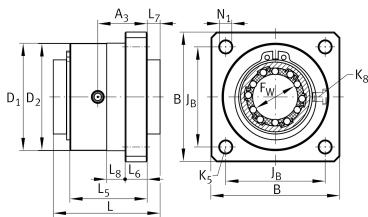

Your current product variant

Size code	40
Seal	PP
Relubrication facility	AS

Technical data

	6	Ball rows
≈m	1,29 kg	Weight

Main Dimensions & Performance Data

F _W	40 mm	Diameter of ball complement
Tol F _W	+ 0,013 mm	Upper tolerance
Tol F _W	- 0,002 mm	Lower tolerance
L	80 mm	Length
B	100 mm	Width
C	6.000 N	Load capacity dyn. C
C ₀	4.400 N	Load capacity stat. C ₀



Mounting dimensions

L ₅	59 mm	
L ₆	16 mm	Thickness
L ₇	9,2 mm	
A ₃	30,3 mm	
N ₁	11 mm	Diameter
K ₅	M10	
D ₁	89,5 mm	Diameter
Tol D ₁	+ 0,2 mm	Upper tolerance
D ₂	90 mm	Diameter
Tol D ₂	g7	Upper tolerance
J _B	78 mm	
L ₈	10 mm	
K ₈	NIPA1	Lubrication nipple