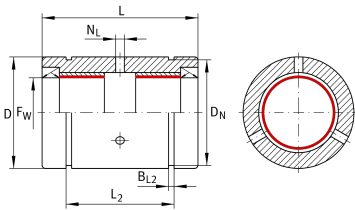

**PAB40-PP-AS**

Linear plain bearing

Linear plain bearing; sealed on all sides, with relubrication facility

Technical information

**Your current product variant**

Size code	40
Seal	PP
Relubrication facility	AS

Main Dimensions & Performance Data

F_W	40 mm	Diameter of ball complement
D	62 mm	Outer diameter
L	80 mm	Length
C_0	600.000 N	Load capacity stat. C_0
$\approx m$	0,445 kg	Weight

Mounting dimensions

L_2	60,3 mm	Mounting Dimension
B_{L2}	2,15 mm	
D_N	59 mm	
N_L	3 mm	