**KGBS30-PP-AS**

Linear Ball Bearing and Housing Unit

Linear ball bearing and housing unit;
adjustable, sealed, greased, with relubrication
facility; corrosion-resistant design possible

Technical information

Your current product variant

Size code	30
Seal	PP
Relubrication facility	AS

Technical data

	6	Ball rows
≈m	0,9 kg	Weight

Main Dimensions & Performance Data

F _W	30 mm	Diameter of ball complement
H	66,5 mm	Height
L	68 mm	Length
Tol L	h12	Tolerance
B	88 mm	Width
C	3.600 N	Dynamic load rating
C ₀	2.850 N	Load capacity stat. C ₀

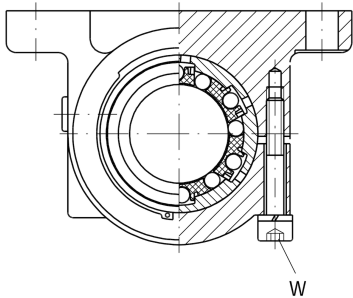
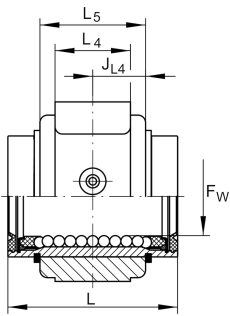
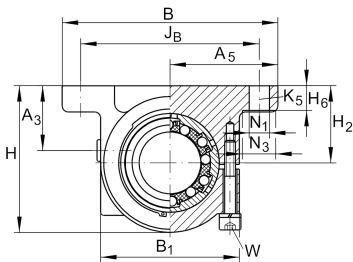



Mounting dimensions

J _B	76 mm	
Tol J _B	+ 0,2 mm	Upper tolerance
Tol J _B	- 0,2 mm	Lower tolerance
B ₁	63 mm	
A ₅	44 mm	
Tol A ₅	+ 0,02 mm	Upper tolerance
Tol A ₅	- 0,02 mm	Lower tolerance
L ₄	32 mm	Distance
L ₅	48 mm	Distance
J L ₄	24 mm	Distance
H ₂	35 mm	Height shaft
Tol H ₂	+ 0,015 mm	Upper tolerance
Tol H ₂	- 0,015 mm	Lower tolerance
A ₃	25 mm	
H ₆	10 mm	
N ₁	6,6 mm	
N ₃	11 mm	
K ₅	M6	
K ₈	NIPA2	Lubrication nipple
W	4 mm	Width across flats