**KGBS40-PP-AS**

## Linear Ball Bearing and Housing Unit

Linear ball bearing and housing unit;  
adjustable, sealed, greased, with relubrication  
facility; corrosion-resistant design possible

## Technical information

## Your current product variant

|                        |    |
|------------------------|----|
| Size code              | 40 |
| Seal                   | PP |
| Relubrication facility | AS |

## Technical data

|    |         |           |
|----|---------|-----------|
|    | 6       | Ball rows |
| ≈m | 1,43 kg | Weight    |

## Main Dimensions &amp; Performance Data

|                |         |                                    |
|----------------|---------|------------------------------------|
| F <sub>W</sub> | 40 mm   | Diameter of ball complement        |
| H              | 83,5 mm | Height                             |
| L              | 80 mm   | Length                             |
| Tol L          | h12     | Tolerance                          |
| B              | 108 mm  | Width                              |
| C              | 6.000 N | Dynamic load rating                |
| C <sub>0</sub> | 4.400 N | Load capacity stat. C <sub>0</sub> |

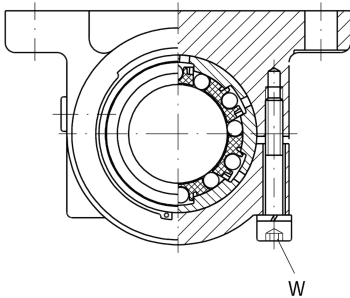
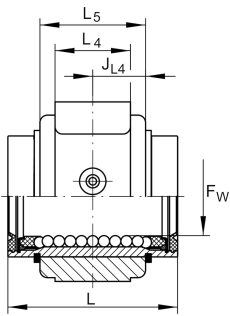
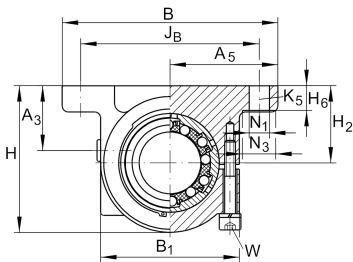



### Mounting dimensions

|                    |            |                    |
|--------------------|------------|--------------------|
| J <sub>B</sub>     | 94 mm      |                    |
| Tol J <sub>B</sub> | + 0,2 mm   | Upper tolerance    |
| Tol J <sub>B</sub> | - 0,2 mm   | Lower tolerance    |
| B <sub>1</sub>     | 77 mm      |                    |
| A <sub>5</sub>     | 54 mm      |                    |
| Tol A <sub>5</sub> | + 0,02 mm  | Upper tolerance    |
| Tol A <sub>5</sub> | - 0,02 mm  | Lower tolerance    |
| L <sub>4</sub>     | 40 mm      | Distance           |
| L <sub>5</sub>     | 56 mm      | Distance           |
| J L <sub>4</sub>   | 28 mm      | Distance           |
| H <sub>2</sub>     | 45 mm      | Height shaft       |
| Tol H <sub>2</sub> | + 0,015 mm | Upper tolerance    |
| Tol H <sub>2</sub> | - 0,015 mm | Lower tolerance    |
| A <sub>3</sub>     | 30 mm      |                    |
| H <sub>6</sub>     | 12 mm      |                    |
| N <sub>1</sub>     | 9 mm       |                    |
| N <sub>3</sub>     | 15 mm      |                    |
| K <sub>5</sub>     | M8         |                    |
| K <sub>8</sub>     | NIPA2      | Lubrication nipple |
| W                  | 4 mm       | Width across flats |