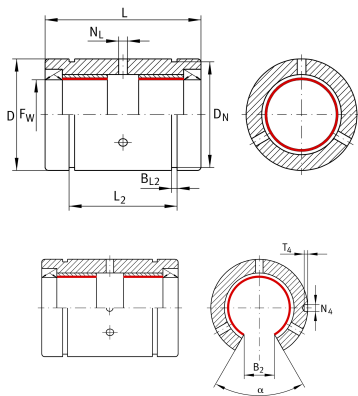
**PABO16-PP-AS** [↗](#)

## Linear plain bearing

Linear plain bearing; open design, sealed on all sides, with relubrication facility

## Technical information

**Your current product variant**

Size code	16
Seal	PP
Relubrication facility	AS

**Main Dimensions & Performance Data**

F <sub>w</sub>	16 mm	Diameter of ball complement
D	26 mm	Outer diameter
L	36 mm	Length
Tol L	h12	Tolerance
C <sub>0</sub>	96.000 N	Load capacity stat. C0
≈m	28 g	Weight



### Mounting dimensions

L <sub>2</sub>	24,6 mm	Mounting Dimension
Tol L <sub>2</sub>	H13	Tolerance
B <sub>L2</sub>	1,3 mm	
Tol B <sub>L2</sub>	H13	Tolerance
D <sub>N</sub>	24,9 mm	
B <sub>2</sub>	10,1 mm	
T <sub>4</sub>	1,2 mm	
N <sub>4</sub>	2,2 mm	
N <sub>L</sub>	2,5 mm	
Tol N <sub>L</sub>	H13	Tolerance
a	78 °	Angle