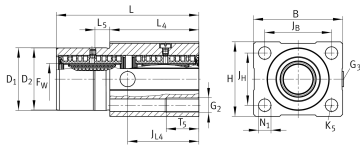
**KTFS16-PP-AS**

## Linear Ball Bearing and Housing Unit

Linear ball bearing and housing unit; with self-aligning linear ball bearing, sealed, greased, with relubrication facility

## Technical information

**Your current product variant**

Size code	16
Seal	PP
Relubrication facility	AS

**Technical data**

	8	Ball rows
≈m	0,255 kg	Weight

**Main Dimensions & Performance Data**

F <sub>w</sub>	16 mm	Diameter of ball complement
H	40 mm	Height
L	78 mm	Length
B	50 mm	Width
C <sub>min</sub>	1.790 N	Load capacity dyn. C
C <sub>0 min</sub>	1.900 N	Load capacity stat. C <sub>0</sub>



### Mounting dimensions

J <sub>B</sub>	38 mm	
Tol J <sub>B</sub>	+ 0,15 mm	Upper tolerance
Tol J <sub>B</sub>	- 0,15 mm	Lower tolerance
L <sub>4</sub>	50 mm	
L <sub>5</sub>	10 mm	
J <sub>L4</sub>	39 mm	Distance
D <sub>1</sub>	35 mm	Diameter
Tol D <sub>1</sub>	g7	Tolerance
D <sub>2</sub>	35 mm	Diameter
Tol D <sub>2</sub>	- 0,1 mm	Upper tolerance
Tol D <sub>2</sub>	- 0,3 mm	Lower tolerance
J <sub>H</sub>	28 mm	
Tol J <sub>H</sub>	+ 0,15 mm	Upper tolerance
Tol J <sub>H</sub>	- 0,15 mm	Lower tolerance
T <sub>5</sub>	18 mm	Thread depth
G <sub>2</sub>	M8	Thread size
N <sub>1</sub>	6,6 mm	Diameter
K <sub>5</sub>	M6	
G <sub>3</sub>	M8x1	Thread size