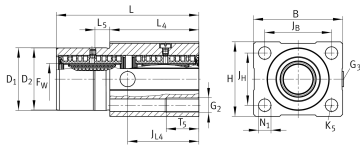
**KTFS20-PP-AS**

Linear Ball Bearing and Housing Unit

Linear ball bearing and housing unit; with self-aligning linear ball bearing, sealed, greased, with relubrication facility

Technical information

**Your current product variant**

Size code	20
Seal	PP
Relubrication facility	AS

Technical data

	8	Ball rows
≈m	0,55 kg	Weight

Main Dimensions & Performance Data

F _w	20 mm	Diameter of ball complement
H	50 mm	Height
L	96 mm	Length
B	60 mm	Width
C _{min}	3.100 N	Load capacity dyn. C
C _{0 min}	3.200 N	Load capacity stat. C ₀



Mounting dimensions

J _B	45 mm	
Tol J _B	+ 0,15 mm	Upper tolerance
Tol J _B	- 0,15 mm	Lower tolerance
L ₄	60 mm	
L ₅	10 mm	
J _{L4}	48 mm	Distance
D ₁	42 mm	Diameter
Tol D ₁	g7	Tolerance
D ₂	42 mm	Diameter
Tol D ₂	- 0,1 mm	Upper tolerance
Tol D ₂	- 0,3 mm	Lower tolerance
J _H	35 mm	
Tol J _H	+ 0,15 mm	Upper tolerance
Tol J _H	- 0,15 mm	Lower tolerance
T ₅	22 mm	Thread depth
G ₂	M10	Thread size
N ₁	8,4 mm	Diameter
K ₅	M8	
G ₃	M8x1	Thread size