



IMAGE COMING SOON



### KGSNG50-PP-AS [↗](#)

#### Linear Ball Bearing and Housing Unit

Linear ball bearing and housing unit; with self-aligning linear ball bearing, sealed, greased, with relubrication facility

### Technical information

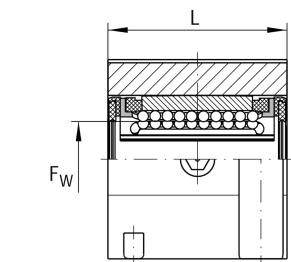
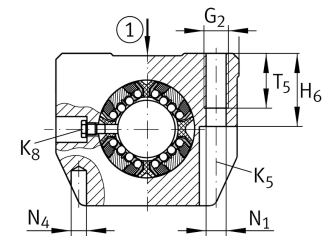
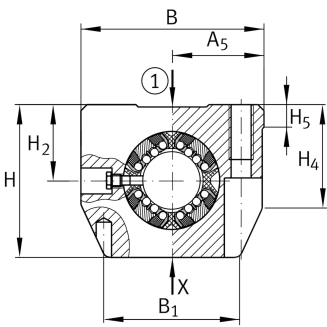

#### Your current product variant

Size code	50
Seal	PP
Relubrication facility	AS

#### Technical data

	8	Ball rows
≈m	2,75 kg	Weight

#### Main Dimensions & Performance Data

F <sub>w</sub>	50 mm	Diameter of ball complement
H	105 mm	Height
B	132 mm	Width
L	100 mm	Length
C <sub>max</sub>	15.100 N	Load capacity dyn.
C <sub>0 max</sub>	13.900 N	Load capacity stat.



### Mounting dimensions

J <sub>B</sub>	108 mm	
Tol J <sub>B</sub>	- 0,15 mm	Upper tolerance
Tol J <sub>B</sub>	+ 0,15 mm	Lower tolerance
B <sub>1</sub>	90 mm	
A <sub>5</sub>	66 mm	
Tol A <sub>5</sub>	+ 0,01 mm	Upper tolerance
Tol A <sub>5</sub>	- 0,01 mm	Lower tolerance
J <sub>L</sub>	50 mm	Distance
Tol J <sub>L</sub>	+ 0,15 mm	Upper tolerance
Tol J <sub>L</sub>	- 0,15 mm	Lower tolerance
H <sub>2</sub>	50 mm	Center height
Tol H <sub>2</sub>	+ 0,008 mm	Upper tolerance
Tol H <sub>2</sub>	- 0,016 mm	Lower tolerance
H <sub>4</sub>	62 mm	
H <sub>5</sub>	10,6 mm	
T <sub>5</sub>	35 mm	
H <sub>6</sub>	49 mm	
G <sub>2</sub>	M16	
N <sub>1</sub>	13,5 mm	
N <sub>4</sub>	10 mm	
N <sub>3</sub>	20 mm	
K <sub>5</sub>	M12	
K <sub>8</sub>	NIP6MZ	Lubrication nipple